

REMOVING THE APPLIANCE (REFER FIGURE 3 - 4)

TURN OFF GAS SUPPLY AND ISOLATE THE ELECTRONIC POWER SUPPLY

- 1) Extract the 4 screw covering caps.
- 2) Completely slacken and remove the 4 retaining screws. Refer figure 3.
- 3) Slacken the drain retaining screws "V", if optional, and remove the stainless steel flange "F". Refer figure 4.

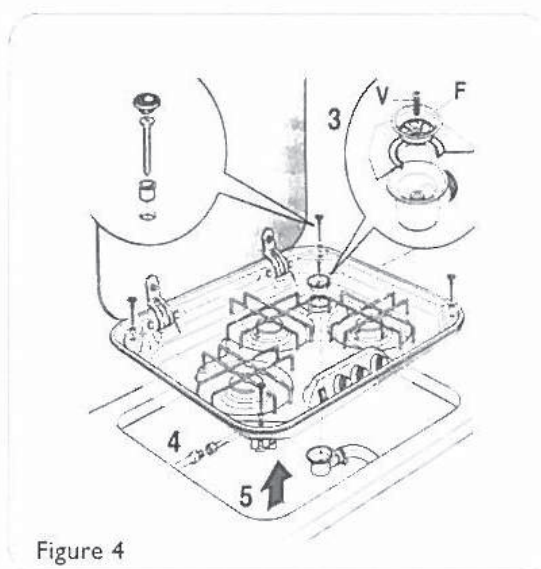
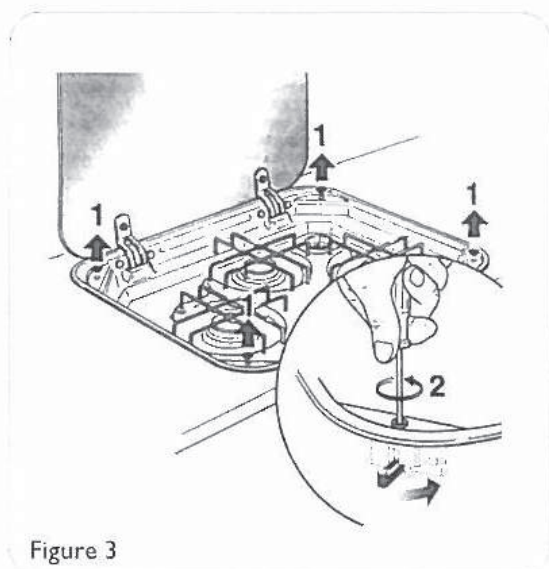

- 4) Disconnect the gas supply pipe and the 12V electric connection.

CIRCUIT DIAGRAM ONLY FOR THREE BURNER MODELS

